

General Process Pressure Gauges (201P Series)

Applications

- Non-corrosive gas, air, oil and water
- Hydraulic systems & machine tools
- Petrochemical processing equipment
- Pumps, compressors and regulators
- Media not attack to brass

Pressure Limitation

- Steady : 3/4 of full scale value
(recommendation : 25% to 75% of full scale)
- Fluctuating : 2/3 of full scale value
(recommendation : lower 50% of full scale)
- Short time : full scale value

Operating Temperature

- Ambient : -40 ~ 60°C
- Media (Fluid) : -5 ~ 60°C



Special Notes

1. This series has been approved by KS B 5305 (Korean Standard).
2. Other Process Connections are available as option.

Standard Specification Overview

Dial Size

- 40mm (1.5"), 60mm (2.5"), 75mm (3"), 100mm (4")

Reference Accuracy

- 40mm : $\pm 3.0\%$ of Full Scale
- 60mm, 75mm, 100mm : $\pm 1.5\%$ of Full Scale

Scale Ranges

- 40mm : 0~0.2 to 0~3.5 MPa
- 60mm, 75mm : Vacuum, Compound & 0 ~ 0.1 to 0 ~ 50 MPa
- 100mm : Vacuum, Compound & 0 ~ 0.1 to 0 ~ 50 MPa
- * For more information, see the ordering information table.

Standard Process Connection

- 40mm : PT ("R" in ISO) 1/8"
- 60mm : PT ("R" in ISO) 1/4"
- 75mm & 100mm : PT ("R" in ISO) 3/8"
- * Throttling hole designed in the pressure port.

Material

- Case : 304 SS
- Ring (Cover) : 304 SS
- Window : Glass(40 & 100mm) Safety Glass(60, 75mm)
- Pointer : Aluminum Alloy, Black Painted
- Connection : Chrome Plated Brass
- Element (Bourdon Tube) : Brass
- Movement : Brass
- Dial Plate : White Aluminum with Black Graduations

Ring Type

- Crimped

Degree of Protection

- 40mm : IP44
- 60mm, 75mm, 100mm : IP65

Optional Extra

- Test Report by Manufacturer
- Test Report by KOLAS (ILAC-MRA)
- Cleaning Service (USE NO OIL)

Ordering Information for 201P Series

● = Standard Products ▲ = Available NA = Not Available

Model	Description	Case & Ring	Wetted Parts			
201P	General Process Pressure Gauges	304 SS	Chorme Plated Brass			
Code	Dial Size	Accuracy	201P			
15	40mm (1.5")	± 3.0% of F.S.	●			
25	60mm (2.5")	± 1.5% of F.S.	●			
30	75mm (3")	± 1.5% of F.S.	●			
40	100mm (4")	± 1.5% of F.S.	●			
Code	Mounting Type	15	25	30	40	
A	Bottom Connection without Mounting Flange	●	●	●	●	
B	Bottom Connection with Back Mounting Flange	NA	●	●	●	
D	Center Back Connection without Mounting Flange	●	●	●	●	
F	Center Back Connection with 3-hole Front Mounting Flange	NA	●	●	●	
Code	Process Connection Style	15	25	30	40	
2	PT ("R" in ISO Standard)	●	●	●	●	
3	PF ("G" in ISO Standard)	NA	●	●	●	
4	NPT	●	●	●	●	
5	UNF	NA	●	●	●	
X	Others	☞	☞	☞	☞	
Code	Process Connection Size	15	25	30	40	
B	1/8"	●	●	●	●	
C	1/4"	●	●	●	●	
D	3/8"	NA	●	●	●	
F	1/2"	NA	●	●	●	
M	7/16"	NA	●	●	▲	
Code	Pressure Range	15	25	30	40	
001	-0.1 ~ 0 MPa	NA	●	●	●	
002	-0.1 ~ 0.1 MPa	NA	●	●	●	
003	-0.1 ~ 0.2 MPa	NA	●	●	●	
004	-0.1 ~ 0.3 MPa	NA	●	●	●	
005	-0.1 ~ 0.4 MPa	NA	●	●	●	
006	-0.1 ~ 0.6 MPa	NA	●	●	●	
007	-0.1 ~ 1.0 MPa	NA	●	●	●	
008	-0.1 ~ 1.5 MPa	NA	●	●	●	
009	-0.1 ~ 2.0 MPa	NA	●	●	●	
112	0 ~ 0.1 MPa	NA	●	●	●	
113	0 ~ 0.2 MPa	●	●	●	●	
114	0 ~ 0.3 MPa	●	●	●	●	
115	0 ~ 0.4 MPa	●	●	●	●	
116	0 ~ 0.6 MPa	●	●	●	●	

118	0 ~ 1 MPa	●	●	●	●
119	0 ~ 1.5 MPa	●	●	●	●
120	0 ~ 2 MPa	●	●	●	●
121	0 ~ 2.5 MPa	●	●	●	●
122	0 ~ 3.5 MPa	●	●	●	●
124	0 ~ 5 MPa	NA	●	●	●
126	0 ~ 7 MPa	NA	●	●	●
127	0 ~ 10 MPa	NA	●	●	●
128	0 ~ 15 MPa	NA	●	●	●
129	0 ~ 25 MPa	NA	●	●	●
130	0 ~ 35 MPa	NA	●	●	●
132	0 ~ 50 MPa	NA	●	●	●

* MPa (SI Unit) is the standard dial scale but others are available upon request.

Code	Applicable Accessory Options
J0	Not Apply
J1	Adapter
J2	Gauge Unions
J3	Syphon Tubes
J4	Pulsation Dampeners
J5	Pressure Snubber
J7	Gauge Savers (Gauge Protectors)
J8	Safety Kloser
J9	Manifold Valves

Code	Options	15	25	30	40
Test Reports					
T1	Test Report by Manufacturer	▲	▲	▲	▲
T2	Test Report by KOLAS (ILAC-MRA)	▲	▲	▲	▲
Other Option					
C1	Cleaning Service (USE NO OIL)	▲	▲	▲	▲

Sample Model Selection : 201P25A2C112J0T1

* The standard specification and price are subject to change without prior notice.

General Process Pressure Gauges (201P Series)

TYPE-A Dial Size 40mm only

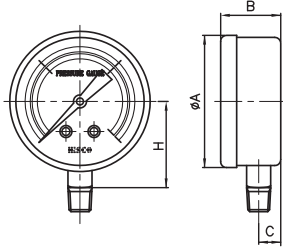

TYPE-D Dial Size 40mm only

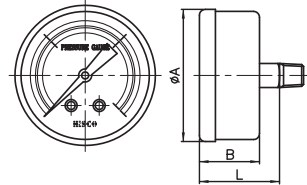

TYPE-A Dial Size 60-100mm

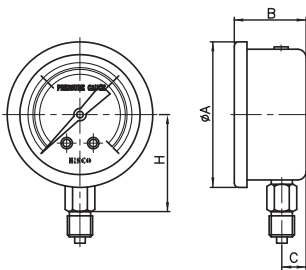

TYPE-B Dial Size 60-100mm

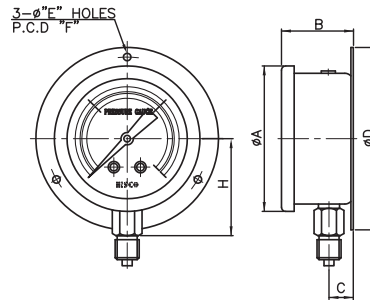

TYPE-D Dial Size 60-100mm

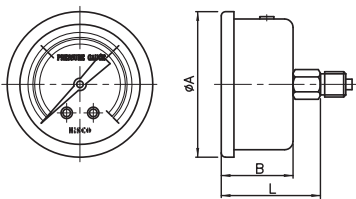

TYPE-F Dial Size 60-100mm

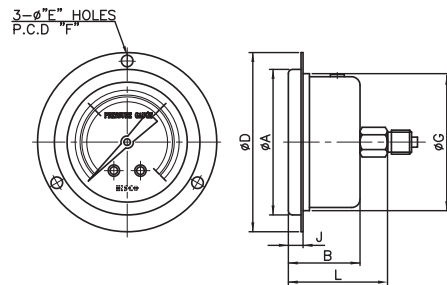

(UNIT : mm)

Code	Dial Size	(Available Type)	A	B	C	D	E	F	G	H	L	J
15	ø40	A,D	46	26	8	-	-	-	-	27.5	34	-
25	ø60	A,B [D,F]	69	32 [34]	10	85 [90]	4.5	77	64	45	48	8
30	ø75	A,B [D,F]	85	33 [37]	11	105	5.5	91.6	80	58	53	8
40	ø100	A,B [D,F]	110	38	11	127.5 [137]	5.5	114 [124]	103	69	52	8

HISCO HISCO, INC.

32, Seonyu-ro 43-gil, Yeongdeungpo-gu, Seoul, Korea
 T : 82-2-2677-6046 F : 82-2-2672-1873 <http://www.hiscoi.com>