

General Process Liquid Filled Pressure Gauges (205P Series)

Applications

- Shock & vibration application
- Non-corrosive gas, air, oil and water
- Hydraulic systems & machine tools
- Petrochemical processing equipment
- Pumps, compressors and regulators
- Media not attack to brass

Pressure Limitation

- Steady : 3/4 of full scale value
(recommendation : 25% to 75% of full scale)
- Fluctuating : 2/3 of full scale value
(recommendation : lower 50% of full scale)
- Short time : full scale value

Operating Temperature

- Ambient : -40~60°C
-20~60°C (Glycerine)
-40~60°C (Silicone)
- Media (Fluid) : Max. 60°C



Special Notes

1. This series has been approved by KS B 5305 (Korean Standard).
2. Other Process Connections are available as option.

Standard Specification Overview

Dial Size

- 60mm (2.5"), 75mm (3"), 100mm (4")

Reference Accuracy

- 60mm, 75mm, 100mm : $\pm 1.5\%$ of Full Scale

Scale Ranges

- 60mm, 75mm, 100mm : Vacuum, Compound & 0 ~ 0.1 to 0 ~ 35 MPa

* For more information, see the ordering information table.

Standard Process Connection

- 60mm : PT ("R" in ISO) 1/4"
- 75mm, 100mm : PT ("R" in ISO) 3/8"

* Throttling hole designed in the pressure port.

Material

- Case : 304 SS
- Ring (Cover) : 304 SS
- Window : Glass(100mm) Safety Glass(60,75mm)
- Pointer : Aluminum Alloy, Black Finished
- Connection : Chrome Plated Brass
- Element (Bourdon Tube) : Brass
- Movement : Brass
- Dial Plate : White Aluminum with Black Graduations Liquid
- Filled : Glycerin (Silicone - Option)

Ring Type

- Crimped

Degree of Protection

- IP 65

Optional Extra

- Test Report by Manufacturer
- Test Report by KOLAS (ILAC-MRA)
- Cleaning Service (USE NO OIL)
- Liquid Filled (Glycerine)
- Liquid Filled (Silicone)

Ordering Information for 205P Series

● = Standard Products ▲ = Available NA = Not Available

Model	Description	Case & Ring	Wetted Parts		
205P	General Process Liquid Filled Pressure Gauges	304 SS	Brass		
Code	Dial Size	Accuracy	205P		
25	60mm (2.5")	± 1.5% of F.S.	●		
30	75mm (3")	± 1.5% of F.S.	●		
40	100mm (4")	± 1.5% of F.S.	●		
Code	Mounting Type		25	30	40
A	Bottom Connection without Mounting Flange		●	●	●
B	Bottom Connection with Back Mounting Flange		●	●	●
D	Center Back Connection without Mounting Flange		●	●	●
F	Center Back Connection with 3-hole Front Mounting Flange		●	●	●
Code	Process Connection Style		25	30	40
2	PT ("R" in ISO Standard)		●	●	●
3	PF ("G" in ISO Standard)		●	●	●
4	NPT		●	●	●
5	UNF		●	●	▲
X	Others		☞	☞	☞
Code	Process Connection Size		25	30	40
C	1/4"		●	●	●
D	3/8"		●	●	●
F	1/2"		●	●	●
M	7/16"		●	●	●
Code	Pressure Range		25	30	40
001	-0.1 ~ 0 MPa		●	●	●
002	-0.1 ~ 0.1 MPa		●	●	●
003	-0.1 ~ 0.2 MPa		●	●	●
004	-0.1 ~ 0.3 MPa		●	●	●
005	-0.1 ~ 0.4 MPa		●	●	●
006	-0.1 ~ 0.6 MPa		●	●	●
007	-0.1 ~ 1.0 MPa		●	●	●
008	-0.1 ~ 1.5 MPa		●	●	●
009	-0.1 ~ 2.0 MPa		●	●	●
112	0 ~ 0.1 MPa		●	●	●
113	0 ~ 0.2 MPa		●	●	●
114	0 ~ 0.3 MPa		●	●	●
115	0 ~ 0.4 MPa		●	●	●
116	0 ~ 0.6 MPa		●	●	●
118	0 ~ 1 MPa		●	●	●
119	0 ~ 1.5 MPa		●	●	●

120	0 ~ 2 MPa	●	●	●
121	0 ~ 2.5 MPa	●	●	●
122	0 ~ 3.5 MPa	●	●	●
124	0 ~ 5 MPa	●	●	●
126	0 ~ 7 MPa	●	●	●
127	0 ~ 10 MPa	●	●	●
128	0 ~ 15 MPa	●	●	●
129	0 ~ 25 MPa	●	●	●
130	0 ~ 35 MPa	●	●	●

* MPa (SI Unit) is the standard dial scale but others are available upon request.

Code	Applicable Accessory Options
J0	Not Apply
J1	Adapter
J2	Gauge Unions
J3	Syphon Tubes
J4	Pulsation Dampeners
J5	Pressure Snubber
J7	Gauge Savers (Gauge Protectors)
J8	Safety Kloser
J9	Manifold Valves

Code	Options	25	30	40
Test Reports				
T1	Test Report by Manufacturer	▲	▲	▲
T2	Test Report by KOLAS (ILAC-MRA)	▲	▲	▲
Other Option				
C1	Cleaning Service (USE NO OIL)	▲	▲	▲
F2	Liquid Filled (Glycerine)	▲	▲	▲
F4	Liquid Filled (Silicone)	▲	▲	▲

Sample Model Selection : 205P25A2C116J0T1

* The standard specification and price are subject to change without prior notice.

General Process Liquid Filled Pressure Gauges (205P Series)

TYPE-A

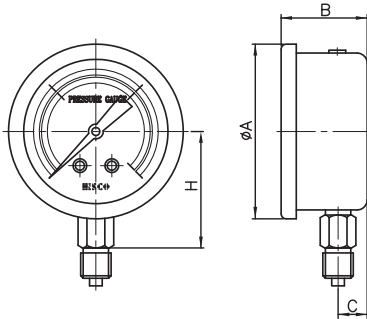

TYPE-B

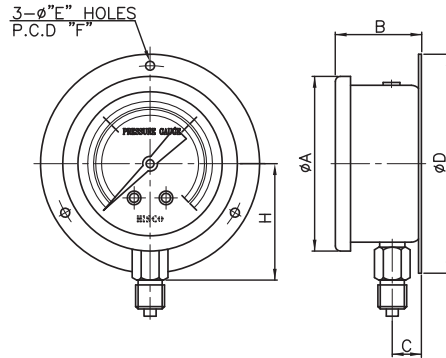

TYPE-D

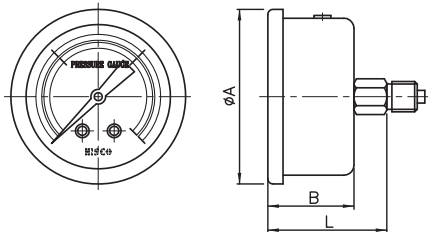

TYPE-F

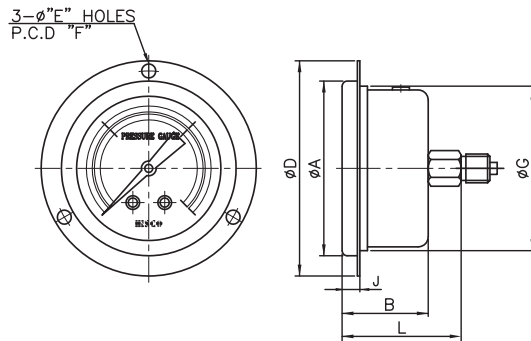

(UNIT : mm)

Code	Dial Size	(Available Type)	A	B	C	D	E	F	G	H	L	J
25	$\phi 60$	A,B (D,F)	69	32 (34)	10	85 (90)	4.5	77	64	45	48	8
30	$\phi 75$	A,B (D,F)	85	33 (37)	11	105	5.5	91.6	80	58	53	8
40	$\phi 100$	A,B (D,F)	110	38	11	127.5 (137)	5.5	114 (124)	103	69	52	8

HISCO HISCO, INC.

32, Seonyu-ro 43-gil, Yeongdeungpo-gu, Seoul, Korea
 T : 82-2-2677-6046 F : 82-2-2672-1873 <http://www.hiscoi.com>